

Application

This provides a complete package for branching a round diffuser off of a main duct. The duct collar mounts the unit directly to the side of the square or rectangular duct, the splitter damper draws air into the branch and can be adjusted for balancing purposes, and the equalizing grid ensures an even air flow into the diffuser.

Standard Features

- Damper adjustment is made from the face of the diffuser via flat-blade screwdriver.
- Extension Rod KXDA can be added on a stub duct mounting.
- Construction is steel.
- Standard finish is electrocoat baked acrylic enamel. Other finishes are available on request.
- Standard color is #04 gray. Other colors are available on request.

Dimensional Data

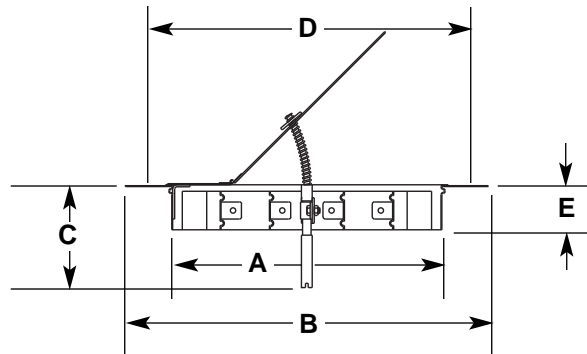

Dim.	Description	5	6	8	10	12	14	16	18	20	24	28	32	36	38
A	Neck Outside Diameter	4-7/8	5-7/8	7-7/8	9-7/8	11-7/8	13-7/8	15-7/8	17-7/8	19-7/8	23-7/8	27-7/8	31-7/8	35-7/8	37-7/8
B	Collar Outside Diameter	7-7/8	8-7/8	10-7/8	12-7/8	14-7/8	16-7/8	18-7/8	20-7/8	22-7/8	26-7/8	30-7/8	34-7/8	38-7/8	40-7/8
C	Control Rod Length	3-1/4	3-1/4	3-1/4	3-1/4	3-1/4	3-1/4	4-3/4	3-3/4	4-3/4	4-3/4	4-3/4	4-3/4	4-3/4	4-3/4
D	Main Duct Cut-Out	5-3/4	6-3/4	8-3/4	10-3/4	12-3/4	14-3/4	16-3/4	18-3/4	20-3/4	24-3/4	28-3/4	32-3/4	36-3/4	38-3/4
E	Unit Depth	1-3/4	1-3/4	1-3/4	1-3/4	1-3/4	1-3/4	2-1/2	2-1/2	2-1/2	2-1/2	2-1/2	2-1/2	2-1/2	2-1/2

Model Numbering System

